



Hobart - 1 Lampton Avenue, Derwent Park
 Launceston - 130 Forster Street, Invermay

Hobart: 6272 8000
 Launceston: 6337 8455 [Search](#)

GRADE 80 ALLOY CHAIN FITTINGS

Grade 80 Master Link

SD Type Head-Rings are designed to cater for single leg and double leg Chain Slings or Wire Rope Sling applications.



[Home](#)

[UPCOMING EVENTS](#)

[About Us](#)

[Chain](#)

[Chain Assemblies](#)

[Dock Leveller](#)

[Electrics](#)

[Fall Protection](#)

[Fittings](#)

[Hoists & Cranes](#)

[Lifting Slings](#)

[Materials Handling](#)

[Manual Lifting](#)

[Pallet Trucks](#)

[Rope / Cordage](#)

[Scissor Lifts](#)

[Slew Jibs](#)

[Tailgates](#)

[Tailgate Hoists](#)

[Testing](#)

[Vacuum Lifters](#)

[Winches](#)

[Wire Rope](#)

[Work Platforms](#)

[Contact Us](#)

[About Us](#)

[Your Privacy](#)

1 double Chain sizes, product ID, grade with mark and Austlift branded.

0 alloy steel, safety factor 4 to 1 for ChainSling , ling.

ble upon request.

CODE	CHAIN SIZE		WLL tonne	Wt. kg	DIMENSIONS		
	1 leg	2 leg			B	C	D
	mm	mm			mm	mm	mm
101006	6		1.25	0.23	60	100	11
101008	8	6	2.5	0.44	70	120	14
101010	10	8	4	0.76	80	140	17
101013	13	10	7.5	1.48	95	160	22
101016	16	13	15	2.25	110	190	25
101022	22	20	25	7.04	150	250	38
101026	26	22	30	7.86	150	250	40
101032	32	26	50	15.2	200	300	50
101036	36	32	63	20.54	200	350	55

G80 Master Link Multi

MD Type Multi Head Rings are designed as a large ring with two intermediate links to cater for two three and four leg Chain Sling or Wire Rope Sling applications.

- Marked with Chain size, product ID, grade with manufacture quality mark.
- Manufactured from G80 alloy steel, safety factor 4 to 1 for Chain Sling , 5 to 1 for Wire Rope Sling.
- Test Certificates available upon request.
- Conforms to AS3776.

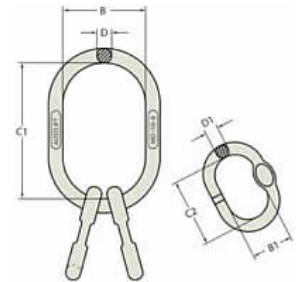

CODE	SIZE	WLL		Wt. kg	DIMENSIONS					
		4:1	5:1		B	B1	C1	C2	D	D1
		mm	mm		mm	mm	mm	mm	mm	mm
101206	6	3.2	2.6	1.7	90	60	160	100	17	14
101208	7, 8	5	4	1.9	90	60	160	100	20	14
101210	10	8	6.4	3.3	120	70	220	150	24	17
101213	13	17	13.6	6.7	140	90	270	160	28	25
101222	22	33	26.4	26.6	180	155	340	285	45	36
101216	16	20	16	9.3	140	100	270	180	32	27
101220	18, 20	26	20.8	19.1	160	140	300	270	40	32

Grade 80 OL Type Omega Links

Austlift OL Type Omega Links are commonly used in conjunction with recessed Head Rings and Chain for Chain Slings.

They are also a popular fitting for variable type slings.

- Marked with Chain size, grade and Austlift branded with manufacture quality mark.
- Made from G80 alloy steel with a safety factor of 4 to 1.
- Test Certificates available upon request. Conforms to AS3776.

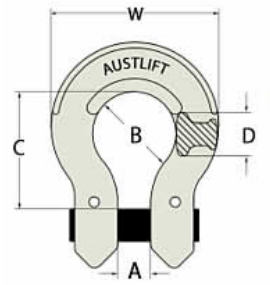

Code	WWL		Dimensions				
	TONNE	kg	A mm	B mm	C mm	D mm	W mm
104106	1.12	0.12	8	20.5	25	12	41
104108	2	0.22	10	23.5	35	16	52
104110	3.15	0.36	12	31.5	40.5	17	62
104113	5.3	0.71	15	41	54	20	81
104116	8	1.3	19	49.5	64	26	99

Grade 80 Shortening Clutch, Clevis

Austlift CC Type Shortening Clutch have the advantage of shortening a Chain Sling without loss of the working load limit of the sling.

The Clevis allows easy connection to Chain.

Not recommended for use as a bottom fitting of sling for back-hooking and reeving applications.

- Marked with Chain size, product ID, grade with manufacture
- Quality mark and Austlift branded.
- Manufactured from G80 alloy steel with a safety factor of 4 to 1
- Conforms to AS 3776, Test Certificates available upon request.

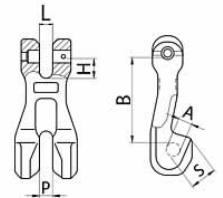

Code	Chain Size	WLL		Dimensions						
		mm	Tonne	kg	A mm	B mm	P mm	L mm	H mm	S mm
102106	6	1.1	0.17	8	44	7.5	7.5	10.3	12	
102108	7,8	2	0.41	10.5	61.7	9.5	9.5	14	17	
102110	10	3.2	0.97	12.4	92	13	13	18.4	28	
102113	13	5.3	2	16	115	16.5	16.5	22.7	34.5	
102116	16	8	3.32	19.5	143	21	21	28.5	40	
102120	18,20	12.5	6.2	23	152	23.5	23.5	33.6	46	
102122	22	15	8.5	26	195	25.5	25.5	39	57.5	

Grade 80 Shortening Clutch, Locking Clevis

Austlift SC Type Lockable Clutches have the advantage of shortening a Chain Sling without loss of the working load limit.

The clevis allows easy connection to Chain with the added safety of a Chain locking devise to prevent the Chain from dislodging from the hook.

- Marked with Chain size, product ID, grade with manufacture
- Quality mark and Austlift branded
- Manufactured from G80 alloy steel with a safety factor of 4 to 1
- Conforms to AS3776, Test Certificates available upon request.

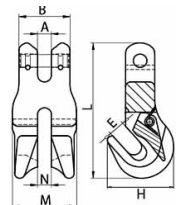

Code	Chain Size	WLL	Dimensions
------	------------	-----	------------

	mm	Tonne	kg	A	B	E	M	N
	mm			mm	mm	mm	mm	mm
102140	10	3.2	0.99	8	44.5	14	56	12

Clutch Choker, Clevis Type

Austlift CC Type Clevis Choker Hooks are a special purpose hook suitable for choke hitch applications. The narrow throat opening prevents the chain from being dislodged. The clevis allows easy connection to Chain.

- Marked with Chain size, product ID, grade with manufacture
- Quality mark and Austlift branded
- Manufactured from G80 alloy steel with a safety factor of 4 to 1
- Conforms to AS 3776
- Test Certificates available upon request

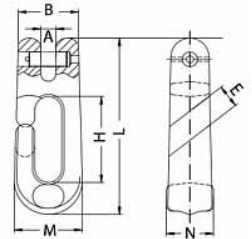

Code	Chain Size	WLL		Dimension			
		mm	Tonne	kg	A	B	H
102420	8	2	0.68	10.5	41	60	46.5

Grade 80 Chain Connectors

CL Type Connecting Links are commonly used to connect Head Rings, Chain, Hooks and other lifting components for Chain Slings and a wide variety of other uses.

- Marked with Chain size, grade and Austlift branded with manufacture quality mark.
- Made from G80 alloy steel with a safety factor of 4 to 1.
- Test Certificates available upon request.
- Conforms to AS3776.

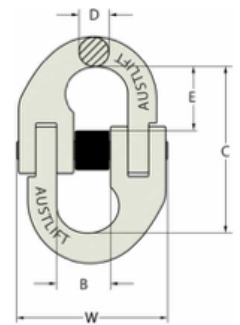

CODE	CHAIN SIZE	WLL	Wt.	DIMENSIONS				
				B	C	D	E	W
	mm	tonne	kg	mm	mm	mm	mm	mm
101806	6	1.12	0.08	15	42	7	18	43
101808	7, 8	2	0.146	18	60.5	8.5	23.5	55
101810	10	3.15	0.3	25	68	11.5	27	69
101813	13	5.3	0.7	29	87	15	32	83
101820	18, 20	12.5	2.1	41	121.5	24	52.5	117
101822	22	15	3.2	48	141.5	26	62	143
101826	26	21.2	4.5	57.5	158	30	64	163
101832	32	31.5	9	67	205	37	86	199

Grade 80 Grab Hook (Clevis Type)

GC Type Clevis grab hook provides the flexibility to shorten Chain Slings and can be used for back-hooking.

Grab Hooks come with supporting lugs to allow no reduction of the working load limit. The Clevis is designed for easy connection of Chain.

- Marked with Chain size, product ID, grade with manufacture quality mark and Austlift branded.
- Made from G80 alloy steel with safety factor of 4 to 1

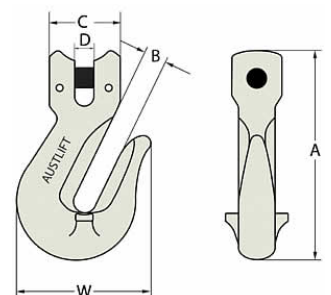

- Test Certificates available upon request.
- Conforms to AS3776.

CODE	CHAIN SIZE	WLL	Wt.	DIMENSIONS				
				A	B	C	D	W
	mm	tonne	kg	mm	mm	mm	mm	mm
101906	6	1.12	0.28	78	8	32	7.5	41
101908	7, 8	2	0.3	108	11	36	9	57
101916	16	8	3.45	204	20	70	17.5	109
101920	18, 20	12.5	5.3	243	23	80	23	130
101922	22	15	7.8	280	26	98	25.5	151
101926	26	21.2	14.5	309	30	110	30	175
101910	10	3.15	0.95	127	13	46	12	70
101913	13	5.3	1.97	163	16	59	15	89

Grade 80 Grab Hook (Eye Type)

GE Type Eye grab hook provides the flexibility to shorten Chain Sling and can be used for back-hooking. Austlift Grab Hooks come with supporting lugs to allow no reduction of the working load limit. The eye is designed for easy connection of Chain Connector.

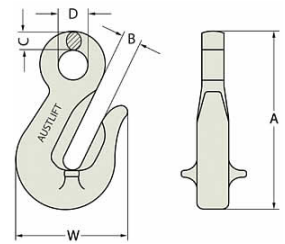

- Marked with Chain size, product ID, grade with manufacture quality mark and Austlift branded
- Made from G80 alloy steel with safety factor of 4 to 1
- Test Certificates available upon request.
- Conforms to AS3776.

CODE	CHAIN SIZE	WLL	Wt.	DIMENSIONS				
				A	B	C	D	W
	mm	tonne	kg	mm	mm	mm	mm	mm
102006	6	1.12	0.25	76.5	8	8	13	45
102008	7, 8	2	0.4	106	11	9.5	16	63
102010	10	3.15	0.6	126	13	12	20	79
102013	13	5.3	1.2	156	16	15	25	100
102016	16	8	2.7	193	20	19	28.5	122
102020	18, 20	12.5	4.3	226	25	20	36	150.5
102022	22	15	6.4	269	26	27	42	169
102032	32	31.5	19.4	361	38	38	57	189

Grade 80 Sling Hook (Clevis Type)

SC Type Clevis Sling Hooks are a general purpose hook suitable for most slinging applications. They come with cast latch for added safety. Clevis allows easy connection to Chain.

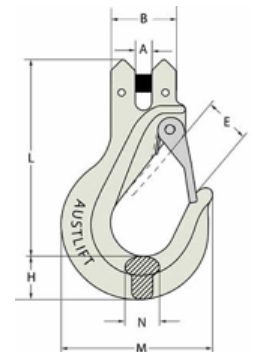

- Marked with Chain size, product ID, grade with manufacture quality mark and Austlift branded.
- Manufactured from G80 alloy steel with a safety factor of 4 to 1.
- Test Certificates available upon request.
- Conforms to AS3776.

CODE	CHAIN SIZE	WLL	Wt.	DIMENSIONS					
				A	B	E	N	H	L
	mm	tonne	kg	mm	mm	mm	mm	mm	
102906	6	1.12	0.3	7.5	32	22	18	20.5	121
102908	7, 8	2	0.5	9	36	25.5	18	23.5	137
102910	10	3.15	0.95	12	46	34	20	30	175.5
102913	13	5.3	1.9	15	59	41.5	29.5	37.5	210.5
102916	16	8	3.45	17.5	70	46	34	42.5	248.5

102920	18, 20	12.5	6.5	23	80	52	45	54	309
102922	22	15	9.65	25.5	98	60	48	76	375.5

Grade 80 Sling Hook (Eye Type)

SE Type Eye Sling Hooks are a general purpose hook suitable for most slinging applications. They come with heavy duty latch for added safety. Eye allows easy connection to coup links and can be attached to lifting apparatus.

- Marked with Chain size, product ID, grade with manufacture quality mark and Austlift branded.
- Manufactured from G80 alloy steel with a safety factor of 4 to 1.
- Test Certificates available upon request.
- Conforms to AS3776.

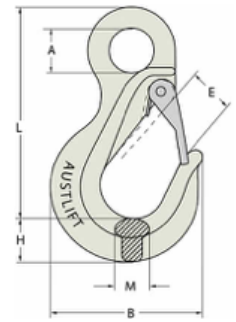

CODE CHAIN SIZE WLL Wt. DIMENSIONS

CODE	CHAIN SIZE	WLL	Wt.	DIMENSIONS					
				A	B	E	H	mm	L
	mm	tonne	kg	mm	mm	mm	mm	mm	mm
103006	6	1.1	0.3	20	74	22	20.5	18	122
103008	7, 8	2	0.5	25.5	83	26	23.5	18	138.5
103010	10	3.2	0.8	32.5	107	34	30	20	176.5
103013	13	5.3	1.9	39.5	134.3	41	37.5	29.5	218
103016	16	8	3.4	50	157.5	44	42.5	34	260
103020	18, 20	12.8	5.3	60	189	52	53	44	310
103022	22	15	8.9	68	239	60	74	50	375.5
103026	26	21.2	13.4	75	245	71	83	63	412
103032	32	31.5	19	88	250	102	95	76	446

G80 Sling Hook (Swivel Type)

SS Type Swivel Sling Hooks are designed with a plain bush bearing swivel thus allowing the hook to swivel under load. Comes with heavy duty Safety Latch.

- Marked with Chain size, product ID, grade with manufacture quality mark and Austlift branded.
- Manufactured from G80 alloy steel with a safety factor of 4 to 1.
- Test Certificates available upon request.
- Conforms to AS3776.
- Spare Latch Kits are available.

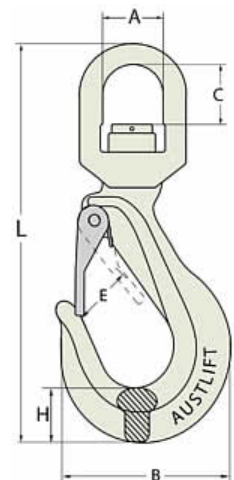

CODE CHAIN SIZE WLL Wt. DIMENSIONS

CODE	CHAIN SIZE	WLL	Wt.	DIMENSIONS					
				A	B	C	E	H	L
	mm	tonne	kg	mm	mm	mm	mm	mm	mm
102808	8	2	0.85	36	88.5	26	27	23.5	190
102813	10	3.15	1.54	42	104.5	34	32	29.5	233
102816	13	5.3	3.04	49	135	41	40	38	291.5
102810	16	8	5.36	61	161	53	45	45.4	352

Grade 80 Self-Locking Hook (Clevis)

LC Type Clevis Self-Locking Hook allows the hook to remain open until the load is engaged. The hook will not open until the trigger at the back is pressed. The clevis

style allows easy connection to the Chain.

- Marked with Chain size, product ID, grade with manufacture quality mark and Austlift branded.
- Manufactured from G80 alloy steel with a safety factor of 4 to 1.
- Test Certificates available upon request.
- Conforms to AS3776.
- Spare Trigger Kits and Load Pins are available

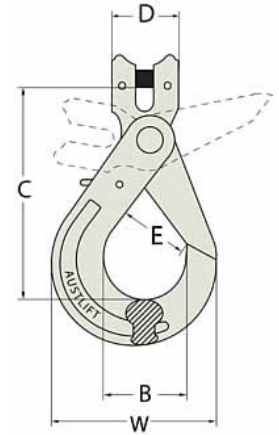

CODE	CHAIN SIZE	WLL	Wt.	DIMENSIONS				
				B	C	D	E	W
	mm	tonne	kg	mm	mm	mm	mm	mm
102206	6	1.1	0.4	34	96	32	28	69
102208	7,8	2	0.7	46	118.5	36	36	88
102210	10	3.15	1.5	58	144	46	45	107
102213	13	5.3	2.7	69	181.5	59	50	138
102216	16	8	5.6	86	216	70	60	182
102220	18, 20	12.5	10.5	92	238	81	72	204
102222	22	15	13.8	98	276	98	78	205
102226	26	21.2	18.2	110	311	118	106	240

Grade 80 Self-Locking Hook (Eye Type)

Austlift LE Type Eye Self-Locking Hook allows the hook to remain open until the load is engaged. The hook will not open until the trigger at the back is pressed. The eye style allows easy connection to Chain Connectors, Shackles and Wire Rope Slings.

- Marked with Chain size, product ID, grade with manufacture quality mark and Austlift branded.
- Manufactured from G80 alloy steel with a safety factor of 4 to 1.
- Test Certificates available upon request.
- Conforms to AS3776.
- Spare Trigger Kits are available.

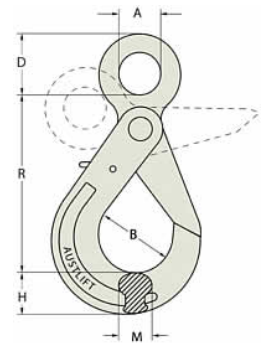

CODE	CHAIN SIZE	WLL	Wt.	DIMENSIONS					
				A	B	D	R	H	M
	mm	tonne	kg	mm	mm	mm	mm	mm	mm
102306	6	1.1	0.5	22	34	10.5	110.5	20	15
102308	7,8	2	0.8	25	46	12	136	24	20
102310	10	3.15	1.5	32	58	13	169	28	26
102313	13	5.3	2.8	40	69	16.5	208	40.5	32.5
102316	16	8	5.4	50	86	20	254.5	50.5	41
102320	18, 20	12.5	10	61	92	26.5	290	62	50
102322	22	15	13.4	72	98	30	320	65	52
102326	26	21.2	18.5	80	110	34.3	362	75	60
102332	32	31.5	44.5	105	166	45	472	97	79.5

Grade 80 Self-Locking Hook (Swivel Type)

LS Type Swivel Self-Locking hook have a ball bearing swivel to allow the hook to swivel under load thus reducing the twist of a sling. Designed with enlarged eye for passing larger Shackles without disassemble of the hook.

- Marked with Chain size, product ID, grade with manufacture quality mark and Austlift branded.
- Ball bearing swivel allows the hook to rotate under full load.
- Manufactured from G80 alloy steel with a safety factor of 4 to 1.
- Test Certificates available upon request.
- Conforms to AS3776.
- Spare Trigger Kits and Swivel Bow head are available.

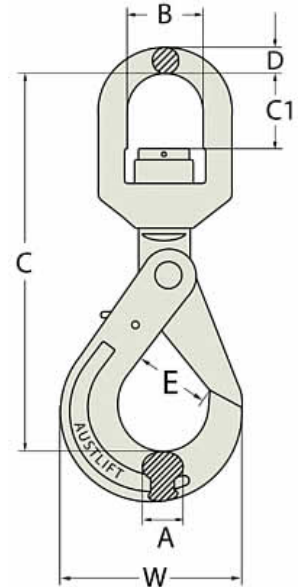

CODE	CHAIN SIZE	WLL Wt.		DIMENSIO			
		tonne	kg	A	B	C	C1
	mm			mm	mm	mm	mm r
102406	6	1.1	0.71	15	32.5	164.5	35 1
102408	8	2	1.12	20	36	204	42 1
102410	10	3.15	2	26	42	240.5	50 1
102413	13	5.3	4	32.5	50	284.5	60 1
102416	16	8	7.3	38	61	350.5	65 2

Grade 80 Grip Self-Locking Hook (Eye Type)

Austlift LE Type Eye Self-Locking Hook allows the hook to remain open until the load is engaged. The hook will not open until the trigger at the back is pressed. The eye style allows easy connection to Chain Connectors, Shackles and Wire Rope Slings.

- Marked with Chain size, product ID, grade with manufacture quality mark and Austlift branded.
- Manufactured from G80 alloy steel with a safety factor of 4 to 1.
- Test Certificates available upon request.
- Conforms to AS3776.
- Spare Trigger Kits are available.

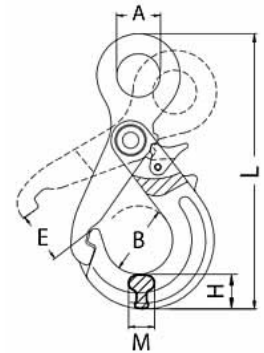

CODE	CHAIN SIZE	WLL Wt.		DIMENSIONS					
		tonne	kg	A	B	E	H	L	M
	mm			mm	mm	mm	mm	mm	mm
102608	8	2	0.75	25	40	34	21.5	163	18
102610	10	3.15	1.2	32	50	42	26.5	201.5	22.5
102613	13	5.3	1.93	40	60	50	31	243.5	29
102616	16	8	3.4	50	70	60	39.5	298	35

Grade 80 Grip Self-Locking Hook (Clevis Type)

Austlift GC Type Clevis Grip-Locking Hook allows the hook to remain open until the load is engaged. The hook will not open until the Trigger at the back is pressed. Clevis style allows easy connection to the Chain and also has a unique design to prevent side loading of the latch.

- Marked with Chain size, product ID, grade with manufacture quality mark and Austlift branded
- Manufactured from G80 alloy steel with a safety factor of 4 to 1.
- Test Certificates available upon request.
- Conforms to AS3776.
- Spare Trigger Kits and Load Pins are available.

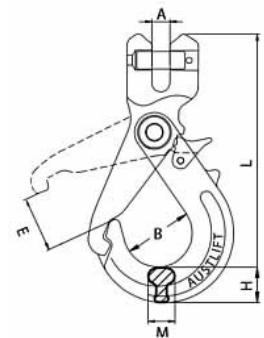

CODE	CHAIN SIZE	WLL Wt.		DIMENSIONS					
		tonne	kg	A	B	H	E	M	L
	mm			mm	mm	mm	mm	mm	mm

	mm	tonne	kg	mm	mm	mm	mm	mm	
102508	8	2	0.8	9.5	40	21.5	36	18	149
102510	10	3.15	1.5	12	50	26.2	44	22.5	189
102513	13	5.3	2.8	15	60	31	54	29	229
102516	16	8	5.1	18	70	39.5	63	35	270

Grade 80 Grip Self-Locking Hook (Swivel Type)

Austlift GLS Type Swivel Self-Locking Hooks are designed with a plain bush bearing swivel to allow the hook to reduce twist under load. They also have a unique design to prevent side loading of the latch.

- Marked with Chain size, product ID, grade with manufacture quality mark and Austlift branded.
- Manufactured from G80 alloy steel with a safety factor of 4 to 1.
- Test Certificates available upon request.
- Conforms to AS3776.
- Spare Trigger Kits and Swivel Bow head are available.

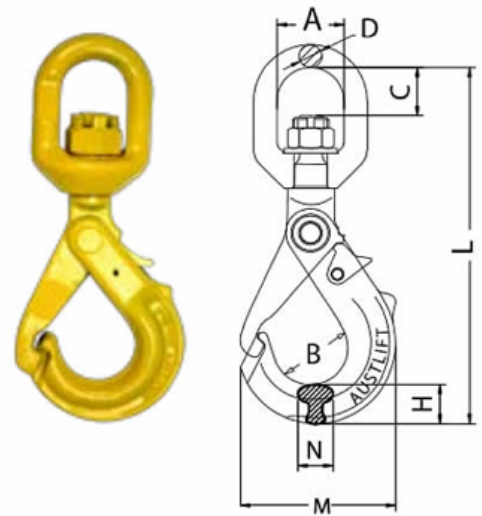

CODE	CHAIN SIZE	WLL	Wt.	DIMENSIC			
				A	B	C	D
	mm	tonne	kg	mm	mm	mm	mm
102710	8	2	0.97	35.5	40	26	12.5
102713	10	3.15	1.83	42	50	33	15
102708	13	5.3	3.3	50	60	39	18

Drum Hook (Eye Type)

Eye Drum Hooks are used in pairs. They are designed to lift and transport steel drum with drum lid in place. Manufactured from grade 80 alloy steel.

- Drop forged and heat treated.
- Conforms to AS3776 for G80 fittings.
- Individually proof tested at 2 x WLL
- Test Certificates available upon request.

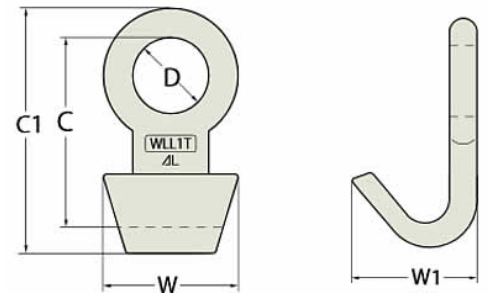

Code	WLL		Dimension:		
	Tonne	C mm	C1 mm	D mm	
104401	1t/pair	109	118.5	38	



Elephants Foot

Elephants Foot are commonly used as a lashing point to secure trucks, cars, container chassis and other vehicles on ships and barges in the marine industry.

- Lashing capacity of 5,000 kg with a minimum break load of 20,000 kg.
- Test Certificates available upon request.

Code	LC Type	MBS kg	WL Tonne	Dimensic			
				A mm	B mm	D mm	C mm

106100	Eye	5000	20	0.67	28	60	16	£
106200	Clevis	5000	20	0.97	16	46	59	-

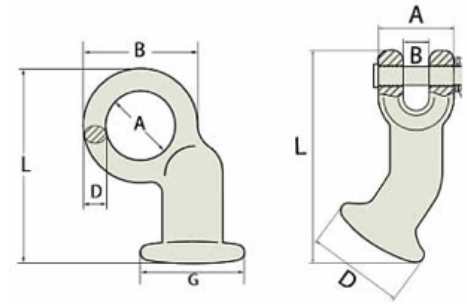

Foundry Hook (Clevis Hook)

FE Type Clevis Foundry Hooks are a special purpose hook with large mouth opening, The clevis allows easy connection to the chain.

- Suitable for lifting pipes and foundry applications.
- Marked with Chain size, product ID, grade with manufacture quality mark
- Manufactured from G80 alloy steel with a safety factor of 4 to 1
- Test Certificates available upon request
- Conforms to AS3776

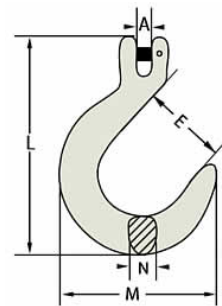

Code	Type	WLL	Weight	Dimer	
				A	E
	mm	Tonne	kg	mm	mm
107008	7,8	2	1.1	9.5	63.4
107010	10	3.15	2.5	13	76.9

Container Hook

Eye Type Container Hooks are a special purpose hook suitable for lifting containers by connection to twist lock pocket.

- The large diameter eye allows most hook sizes to fit.
- There is left and right hand configurations and a straight configuration available.
- Marked with Chain size, product ID, grade
- Manufacture quality mark
- Manufactured from G80 alloy steel with a safety factor of 4 to 1
- Conforms to AS 3776, Test Certificates available upon request.

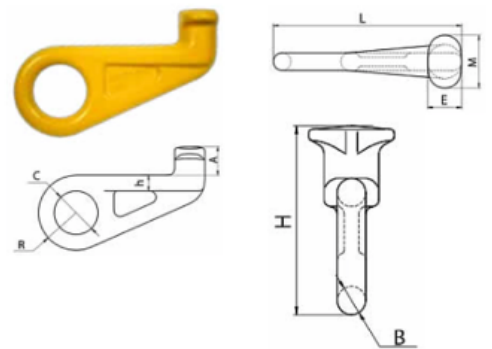

Code	Type	Chain Size		WLL	Weight	Dimensions							
		G 80 mm	G 100 mm			A	B	C	E	R	M	L	
				kg		mm	mm	mm	mm	mm	mm	mm	mm
104410	Straight	20	19	12.5	4	46	25	70	48	60	75	265	

104412	LH 45	20	19	12.5	4	46	25	70	48	60	75	265
104413	RH 45	20	19	12.5	4	46	25	70	48	60	75	265

Weld on Point

Austlift WP Type Weld on Lifting Points can be welded on any carbon steel surface as a lifting point, or to be used as a fixed anchor point for spreader beam attachment. Can also be used as an anchor point for load restraint applications.

- Marked with work load limit, product ID, grade with manufacture quality mark
- Manufactured from treated alloy steel with safety factor of 4:1
- Conforms to AS3776
- Welding instructions supplied with each unit

Code	WLL		Weight		Dimensions			
	Tonne	kg	B mm	D mm	C mm	C1 mm		
104001	1	0.55	55	14	35	95.7		
104003	3	0.9	64	17	50	99		
104005	5	1.8	70	22	70	137		
104008	8	2.5	85	26.5	90	144		

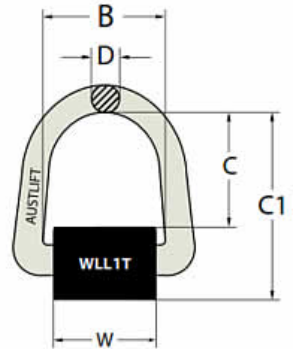

Universal Weld on Hook (with Latch)

WH type Weld-on Hooks are a versatile hook for lifting and spreader beam attachment applications. They can also be used for any fixed anchor point after welding the hook on.

- Marked with work load limit, grade with manufacture quality mark.
- Made from G80 alloy steel with safety factor of 4:1
- Conforms to AS3776, Test Certificates available upon request.
- Welding instructions supplied with each unit

Code	Chain Size mm	WWL		Weight kg	Dimensic	
		Tonne	Tonne		B mm	E mm
103801	6	1.1	5.5	0.35	53	18
103802	7, 8	2	10	0.55	63.5	26
103803	10	3.2	16	0.87	75	30
103805	13	5.3	26.5	1.75	92.5	35
103808	16	8	40	3	106	40
103812	22	12.5	62.5	6.16	140	51

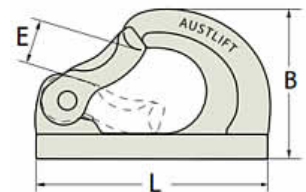

Chain Slings Made to Order

Tas Lifting Sales & Servicing can make chain slings to your requirements and deliver to anywhere at a competitive price. Simply [contact us](#) for a quote....



[Brierley Hose & Handling - Hose Supplies](#) [Contact Us](#)
[Brierley Marine - Chandlery](#) [About Us](#)
[Tas Lifting - Lifting Sales & Servicing](#) [Your Privacy](#)

Web Design by Solstice Digital